

AUSTIN PUBLIC LIBRARY & SECOND STREET BRIDGE

Exterior Enclosure and Railing
Austin, Texas, USA

M44-2



L-115

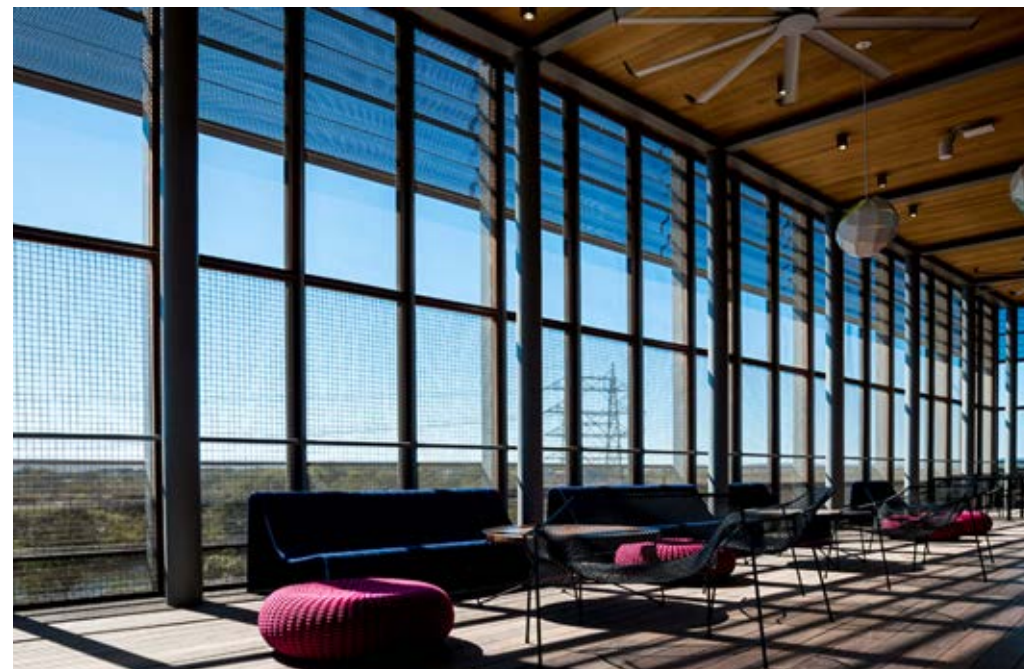
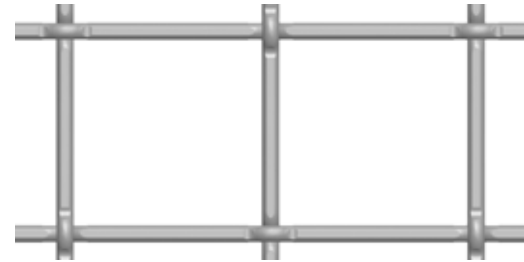

Designed by award-winning Lake Flato Architects and Shepley Bullfinch, the building, which overlooks the iconic Lady Bird Lake, has earned multiple awards and was listed a TIME Magazine 'Best Place to Visit in 2018'. Banker Wire's M44-2, L-115 wire mesh were both sourced for the library's exterior design. The L-115 2-inch wire mesh was applied in a screen format to the open-air reading porch—a covered outdoor extension of the children's library—designed to enhance their reading experience and spark imagination, by allowing the natural light to flood the room. This large square weave was selected in Powder Coated finish and can be woven in a variety of alloys including stainless steel, plain steel, weathering steel, pre-galvanized, Galfan®, aluminum, bronze, brass, and copper.

Banker Wire's M44-2 was selected in stainless steel for the 2nd Street Bridge, the 2nd Street right-of-way, and the Shoal Creek Greenbelt, just outside of the Library. The contemporary, high definition lock crimp weave of M44-2 with a 4.5-inch square pattern provides a beautiful consistent repeat pattern. Integrated with lighting, the mesh application on the bridge helps to reflect and illuminate the walkway at night, linking the new library property and redeveloped neighborhood with downtown Austin.